

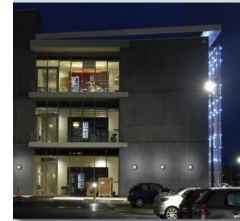

Comet

Comet is a classic decorative and energy efficient round bulkhead for use with a range of compact fluorescent lamps in commercial and public lighting applications



Materials and Finish

- High pressure die cast LM6 aluminium base
- High pressure die cast LM6 aluminium trim ring, finished in a special multi stage satin finish powder coating
- Opal high impact acrylic diffuser
- 0.8mm white powder coated mild steel removable gear tray, stainless steel version available on request
- Silicon sponge gasket
- Stainless steel Allen head screws

Features

- Ingress protection: IP 66
- Suitable for electronic control gear and lamps for energy saving and dimming applications where required
- All control gear components mounted on a removable gear tray, mounted to the base with three keyhole slots
- Control gear trays can be installed after base mounting, allowing protection against damage or theft on site
- 3mm high studs provided on the base, ensuring that no rainwater runs over the luminaire surface when installed, keeping it clean for longer
- Suitable for 2*26W PL-C 4P lamps, offering a lumen package of 3600 lumen

Installation

- 3 mounting holes provided outside the lamp compartment
- Grommet with prewired tails provided in the base casting
- 3 captive stainless steel Allen head screws to fasten the trim ring onto the body

Application Areas

- Commercial buildings
- Public buildings
- Office parks
- Industrial developments

Suitable Lamp Types

- PL-S 9W 2P or 4P
- PL-C 13/18/26W 2P or 4P
- 14W LED
- 24W LED



1 - Available with ECG up to 26W PL-C 4P

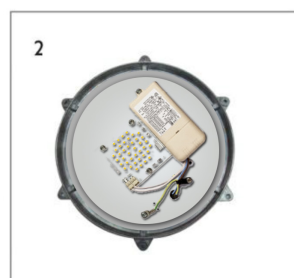

2 - Supplied with LED 14W, 18W or 24W



3 - Captive Allen head screws to fasten the trim ring to the base

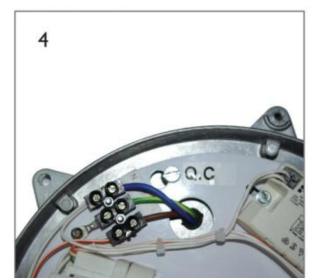

4 - Keyhole slots on the removable gear tray allows easy installation and replacement

Dimensions

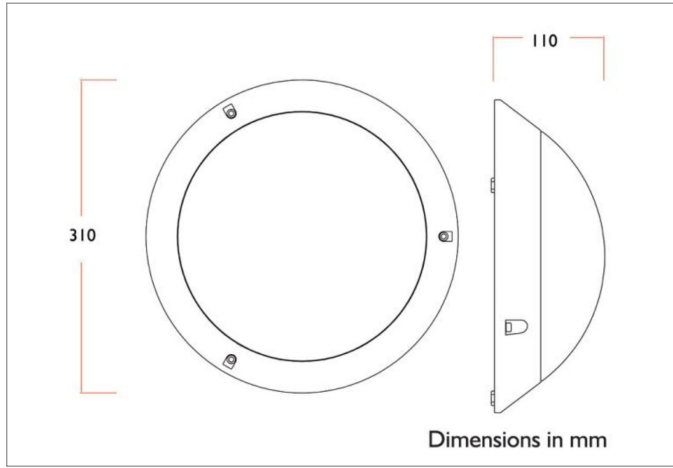

Photometric Data

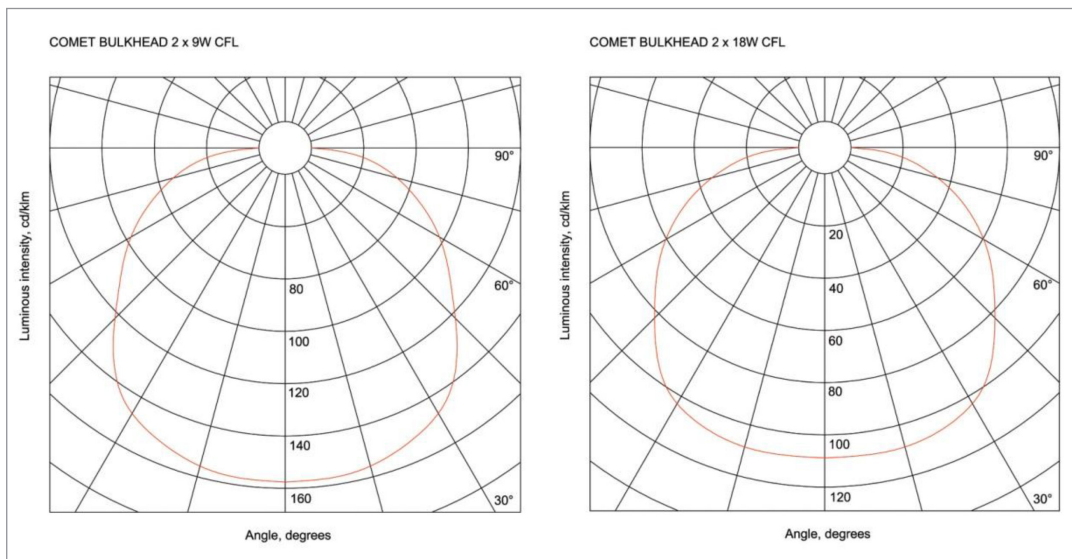

Accessories

- EM - emergency luminaire, maintained or non-maintained - specify requirements
- HELI - stainless steel helicoil inserts for coastal environments
- SC - standard colour BLACK, specify special colours available on request

Options



Grid : Ass half





Grid : Ass quarter



Grid : Ass third

Ordering Data

Full product name	Lumen	Weight
COMET 1*PL-S 9W 2P	600	1.9
COMET 1*PL-C 13W 2P	900	1.9
COMET 1*PL-C 18W 2P	1 200	1.9
COMET 1*PL-C 26W 2P	1 800	2.0
COMET D 2*PL-S 9W 2P	1 200	2.3
COMET 2*PL-C 13W 2P	1 800	2.3
COMET 2*PL-C 18W 2P	2 400	2.3
COMET 1*PL-S 9W 4P	600	1.6
COMET 1*PL-C 13W 4P	900	1.6
COMET 1*PL-C 18W 4P	1 200	1.6
COMET 1*PL-C 26W 4P	1 800	1.6
COMET 2*PL-S 9W 4P	1 200	1.8
COMET 2*PL-C 13W 4P	1 800	1.8
COMET 2*PL-C 18W 4P	2 400	1.8
COMET 2*PL-C 26W 4P	3 600	1.8
 COMET LED 14W 45*0.3W	1050	1.4
 COMET LED 24W	1 800	1.4

EPIC LIGHTING

PO Box 50940, Wierda Park, 0149286
 Research Rd, Unit 4, Pretoria West
 087 711 0267 | info@epiclighting.co.za



www.epiclighting.co.za